

Keyplan

Not to Scale



SDR CONSTRUCTION
Creates your unique ID...

2/3 V.O.C Nagar, 2nd Street, Anna Nagar East, Chennai - 600 102.

Tel : 044-4509 0323, Mob : 9840026130, 9840757732

Email : rajesh@sdrconstruction.org



SDR CONSTRUCTION
Creates your unique ID...

www.sdrconstruction.in



Elevation

Site Layout

Ground Floor

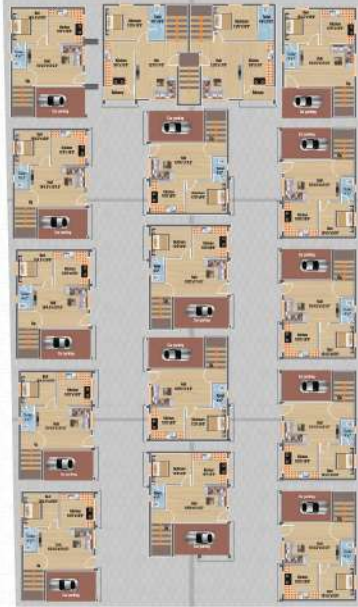

First Floor



Ground Floor



First Floor





Specification

Structure	: RCC frame structure with 9" brick external walls and 4 1/2" brick partition wall.
Design	: Architect design as per vastu.
Plastering	: Ceiling, inner & outer walls plastering in cement with neat finish.
Flooring	: 2' x 2' Vitrified Tiles in all rooms with 4" skirting.
Main door	: Quality Teak Wood frame with Panelled door with varnish finish and brass fittings.
Other door	: Quality Country Wood frame with flush door with enamel Paint and power coated fitting.
Window	: Wood frame with glazed shutters - openable windows with M.S. Grills.
Plumbing	: Concealed CPVC Pipe Line in bathroom, PVC pipes for rain water, sanitary waste
Sanitary	: Line and under ground drainage. Bath rooms with bore well water.
Kitchen	: 20 mm Black granite counter with stainless steel sink with drain board, will be provided.
Toilet	: EWC / IWC white color sanitary ware (Parryware or Equivalent) Washing machine point, Geyser point, One shower point, Glazed tiles upto 7' height, Wash Basins.

Painting	: Grills - Zink Chromite non-corrosive primer with enamel paint.
Electrical	: Three Phase power supply with concealed wiring of ISI Anchor Switches or Equivalent Earth leak circuit breaker. The electrical points as per architects drawing.
Finishes	: Internal Surface will be finished with two coat of path with Acrylic Emulsion Paint. Exterior Surface shall be finished with ACE acrylic emulsion paint.
Staircase	: Railing - MS Grill.
Rainwater	: Rain water harvesting will be done.
Pest control	: Pre construction anti-termite treatment.
Generator	: Will be provided.

